

Zur Stabilität löten Sie am oben Ende der Glasstäbe einen Metallring 9216301( D=20cm ) an.  
 For reinforcement solder a 20cm metal ring ( 9216301 ) to the upper end of the glass rods.

Dachspitze = Lampenkappe 25mm ( 2211000 )  
 Endknopf 16mm ( 2113000 )

Roof top = lamp cap 25mm ( 2211000 )  
 final 16mm ( 2113000 )

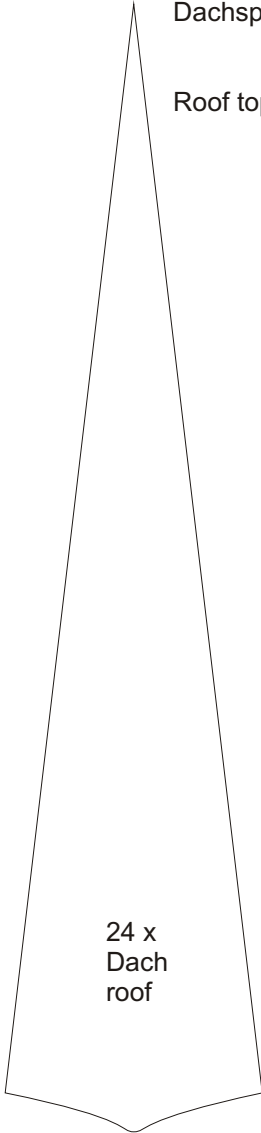

6 Seiten / 6 sides

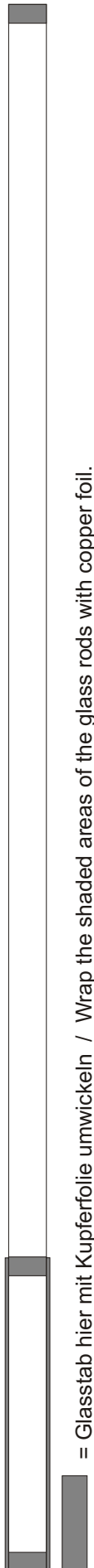
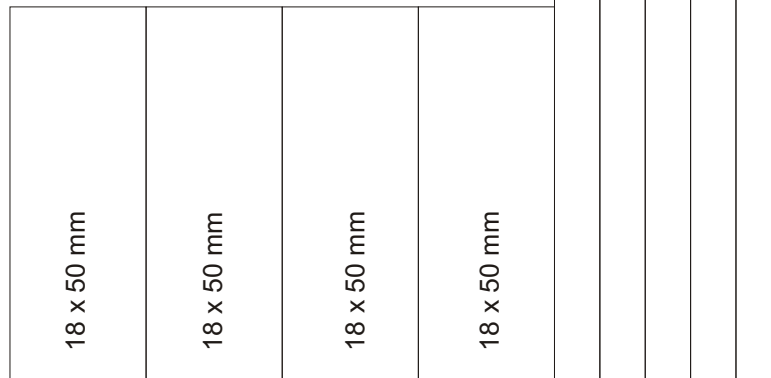

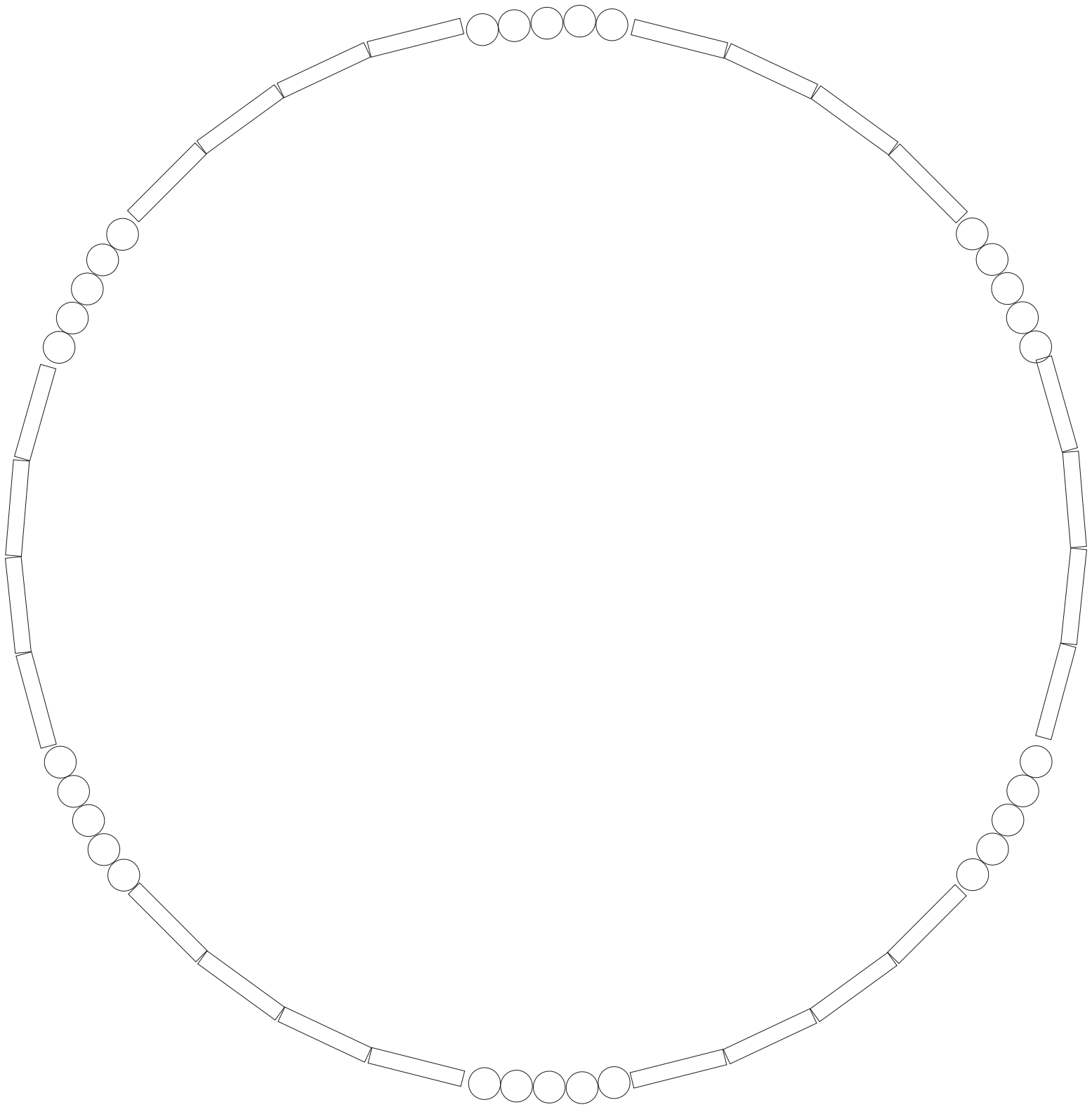



Boden ( schwarzes Glas )  
Bottom ( black glass )